

Tee nut

General information:

Shaped in sheet metal.

It is available in dimensions M3-M10.

Field of application:

The nut is pressed into a pre-drilled hole in the wooden design. The flaps lock the nut and prevent rotation.

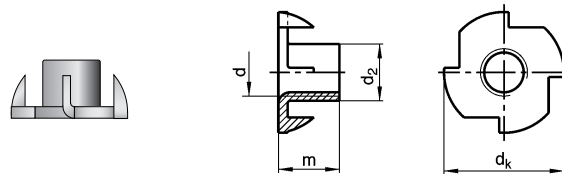

Speed nut

The speed nut is available in several different designs.

General information:

It is manufactured from spring steel and stainless steel.

Field of application:

It is used in material thickness 0,7-6,0. When there are existing holes. The clamping force is limited.

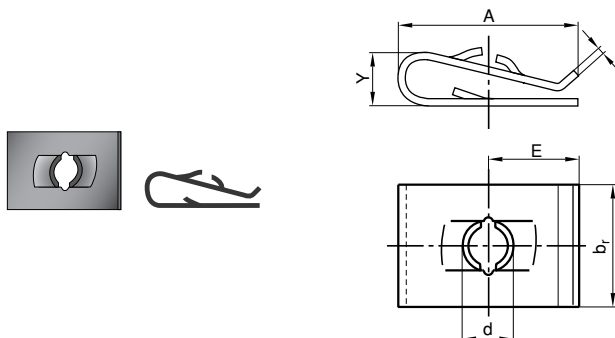

General information:

It is manufactured from spring steel.

Field of application:

The speed nut is independent of the material's thickness. When assembled, the nut's shape makes it self-locking.

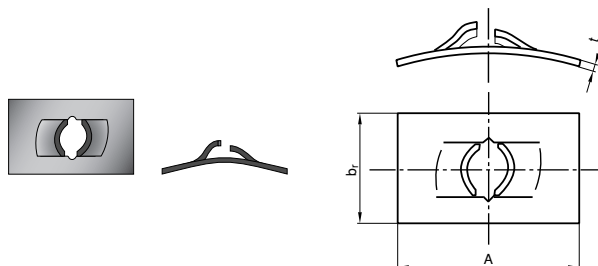

Cage nut

General information:

The cage nut is available in several different designs. The cage is delivered in stainless steel A2, with a zinc-plated nut. It is available in dimensions M3-M10.

Field of application:

It is used when fast assemblage is needed. The nut in the cage is self-centred, which allows a certain amount of play between screw and nut.

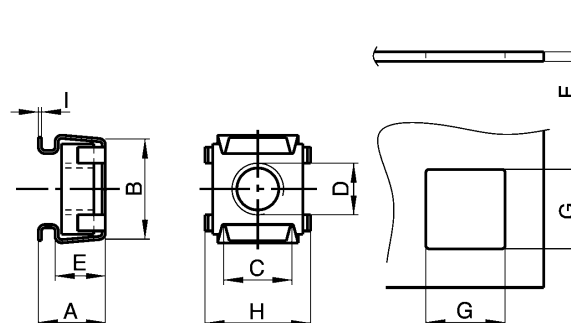

Assembly instruction:

